



CO-EX
CORPORATION

TRANSLUCENT
POLYCARBONATE
MULTI-WALL
PANEL SYSTEMS

- Skylights
- Canopies
- Walkways
- Wall Systems
- Interiors



BDL POLYCARBONATE PANEL SYSTEMS

CO-EX'S BDL® is a system of standing seam modular panels used to create vertical and sloped glazing. It is suited for a range of applications from curved skylights to interiors. Thanks to its wide variety of accessories, the system is complete, versatile, lightweight, and easy to install.

CO-EX BDL panel system is highly versatile and suitable for a wide range of daylighting applications such as:

- SKYLIGHTS
- CANOPIES
- INTERIOR SYSTEMS
- WALKWAYS
- WALL SYSTEMS

The CO-EX BDL polycarbonate panel offers many advantages when compared with other glazing alternatives.

HIGH IMPACT RESISTANCE – 200 times greater than glass

LIGHTWEIGHT – less than 1 lb. per sq. ft.

TRANSLUCENT – controlled natural daylight

DOUBLE SIDED U.V. PROTECTION – either side may be exposed to the weather

FLAME SPREAD/SMOKE DEVELOPMENT – excellent behavioral properties

EASY TO INSTALL – complete system and accessories

SAVES ENERGY – excellent thermal properties

HIGHLY FLEXIBLE – cold forms to a 11' radius, heat formed even tighter

- Wide Range of Colors
- No Adhesives Required
- Clean Aesthetics Created by Snap Covers
- Thermal Movement is Captured Internally within the System
- Unique panel construction
- Superior Light Diffusing Properties
- High U.V. Resistance on Both Side

Photos courtesy of EXTECH® Exterior Technologies:
Left top and bottom, Lessin Tennis Court Building, Englewood Cliffs, NJ, and Clean Town Car Wash, Pittsburgh, PA, right, SAIC Future Combat Systems Building, Washington, DC. Cover 2nd and 3rd from top, Lessin Tennis Court Building, Englewood Cliffs, NJ



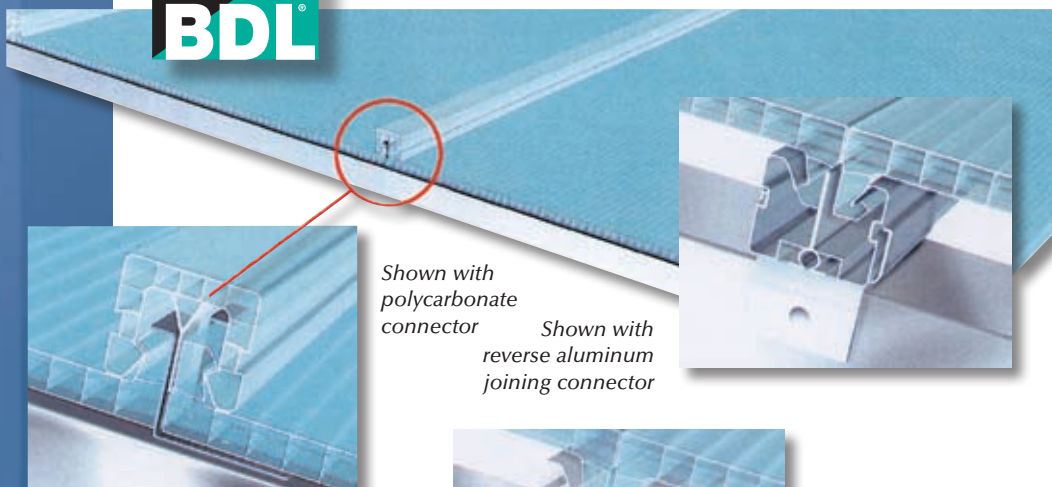

Shown with
polycarbonate
connector

Shown with
reverse aluminum
joining connector

Shown with reverse
steel joining connector

PANEL CLIPS feature the CO-EX "GRIPLOCK" Connection System

Exceeds All OSHA
Fall Through and
Point Load
Requirements

Polycarbonate

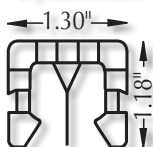

Aluminum

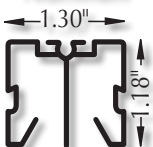

Steel

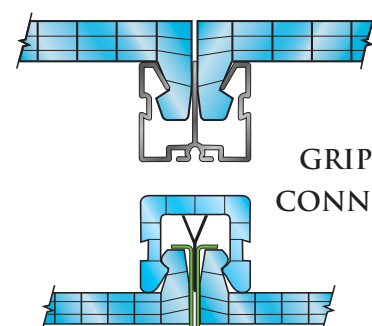
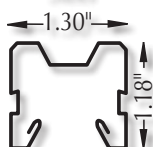

GRIP LOCK
CONNECTORS

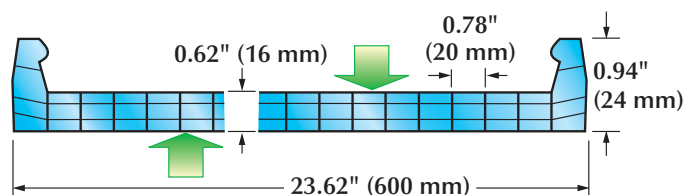
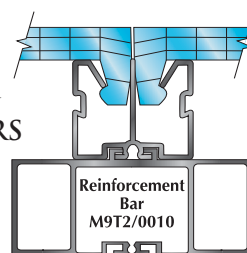

TECHNICAL DATA

- BDL 16 Thickness: 0.62" (16 mm)
- Width: nominal 23 5/8" (600 mm)
- Length: up to 39'
- Colors: Clear, Bronze, Opal, Green, Opalescent, Ice Mist and Blue
- Panel Wt: 16mm – .71 lbs./sq. ft.
- U.V. Protection: by co-extrusion, both sides
- CC-1 Classified Material: Per ASTM D635
- Flammability/Smoke Development: Per ASTM E-84 Class 1/Class A is available.
- Color Change: No more than 3 Delta Units per ASTM D2244-05 after 5 years, and 6 after 10 years – non pro-rated

CO-EX BDL 16 Meets or Exceeds the Following Tests:

- ASTM D2843 Smoke Density
- ASTM D1929 Self Ignition
- ASTM D635 Burning Extent
- ASTM E84

BDL System Acceptance:

MEA - New York City
MEA - #180-02-M

BDL 16 SYSTEM

16 mm PANELS	CLEAR	OPAL	ICE MIST	BRONZE	GREEN	BLUE
Light Transmission (%)	63	21	48	31	59	58
Shading Coefficient	.77	.55	.68	.65	.74	.73
Solar Transmission (%)	.67	.28	.59	.57	.65	.64
U-Value, Btu/ft ² h°F	0.41	0.41	0.41	0.41	0.41	0.41
R-Value (1/u) ft ² h°F/Btu	2.44	2.44	2.44	2.44	2.44	2.44



MODULIT 500 LP WALL SYSTEMS

Modulit[®] 500 LP

CO-EX MODULIT 500 LP system is suitable for any vertical translucent glazing application such as:

- CLERESTORY GLAZING
- EXTERNAL TRANSLUCENT WALLS
- INTERNAL TRANSLUCENT PARTITIONS

USE OF PANEL CLIPS

If necessary, due to the glazing height or to the high load required, several intermediary supports must be installed and the fixing must be made with the aluminum clips.

These clips allow a solid anchoring but do not prevent the thermal expansion of the polycarbonate panel.

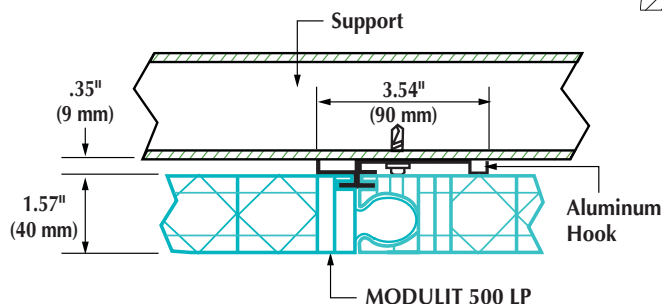

CO-EX MODULIT 500 LP
meets or exceeds the following tests.

ASTM D2843	ASTM D1929
ASTM D635	ASTM E84

ANCHOR DETAIL

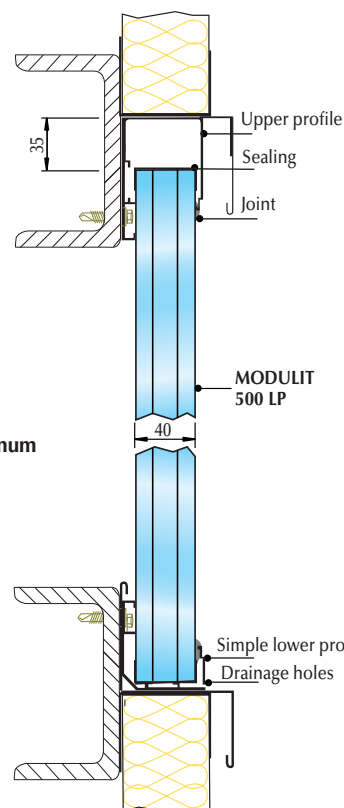

TYPICAL PANEL DETAIL

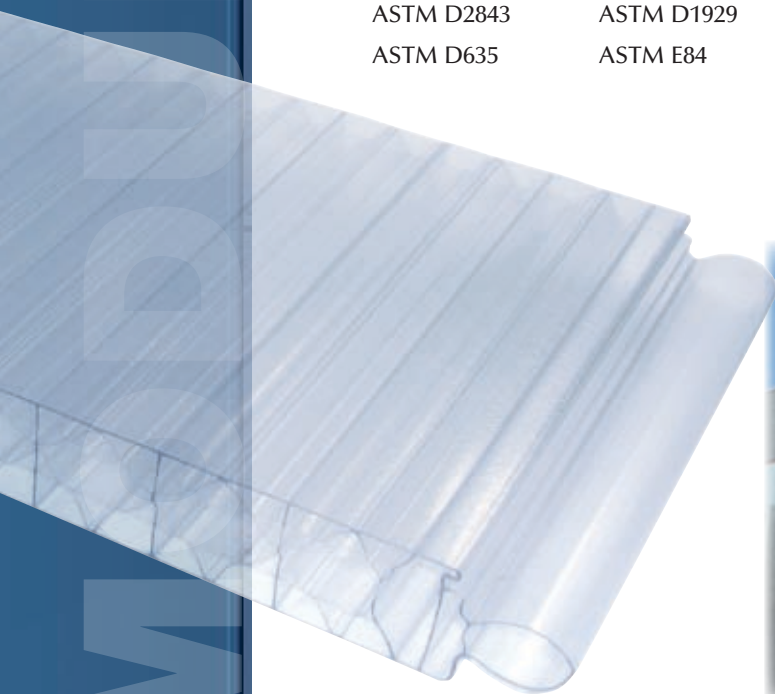
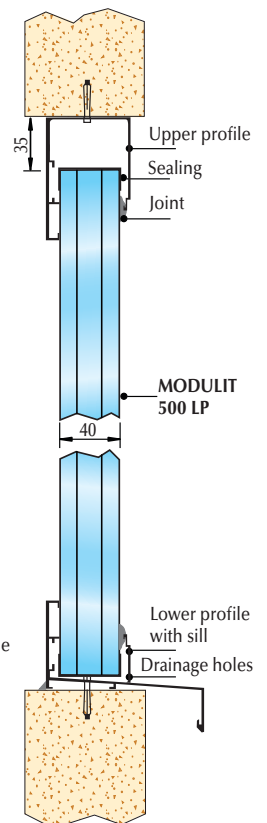

Modulit[®] 500 LP

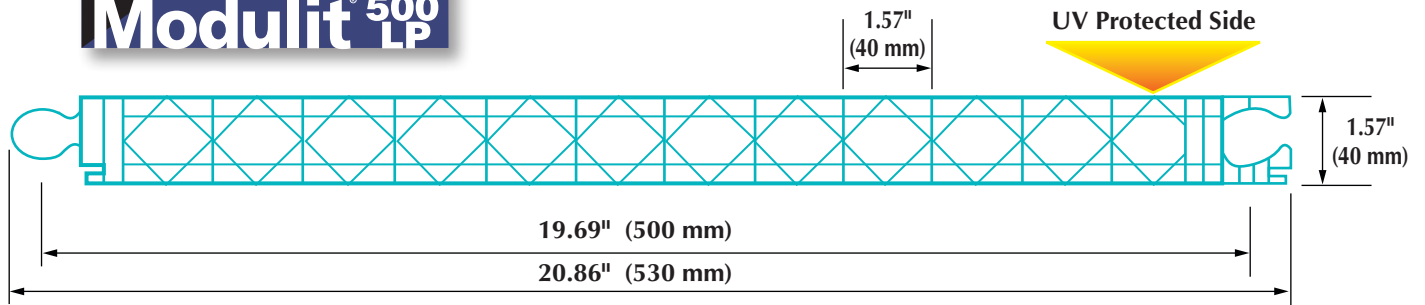

MODULIT 500 LP

TECHNICAL DATA

Thickness	1.57" (40 mm)
Width	20.86" (530 mm)
Module Width	19.68" (500 mm)
Rib Distance	1.57" (40 mm)
Maximum Length	39' or upon request
Thermal Insulation, Btu/ft ² h°F	U = .25

Colors	Light Transmission	
	Clear (8005)	68%
	Opal (8121)	47%
UV Protection	Co-extruded on external side (both sides on request)	
Warranty	10 years against yellowing, hail & light transmission	
Temperature of use	-22°F 248°F	
Sound Insulation	23 dB	
Thermal Expansion Coefficient	.036 ft / ft°F	

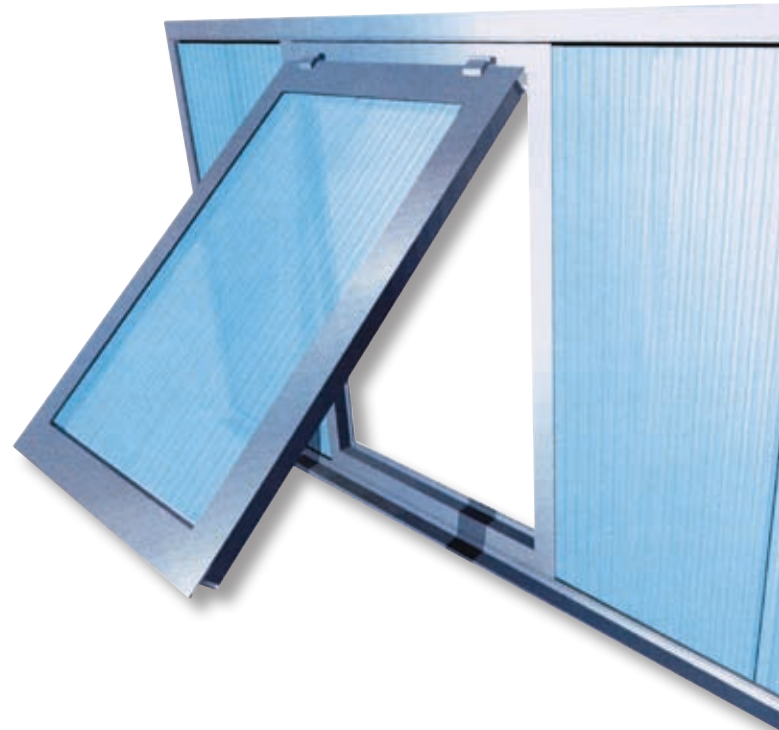
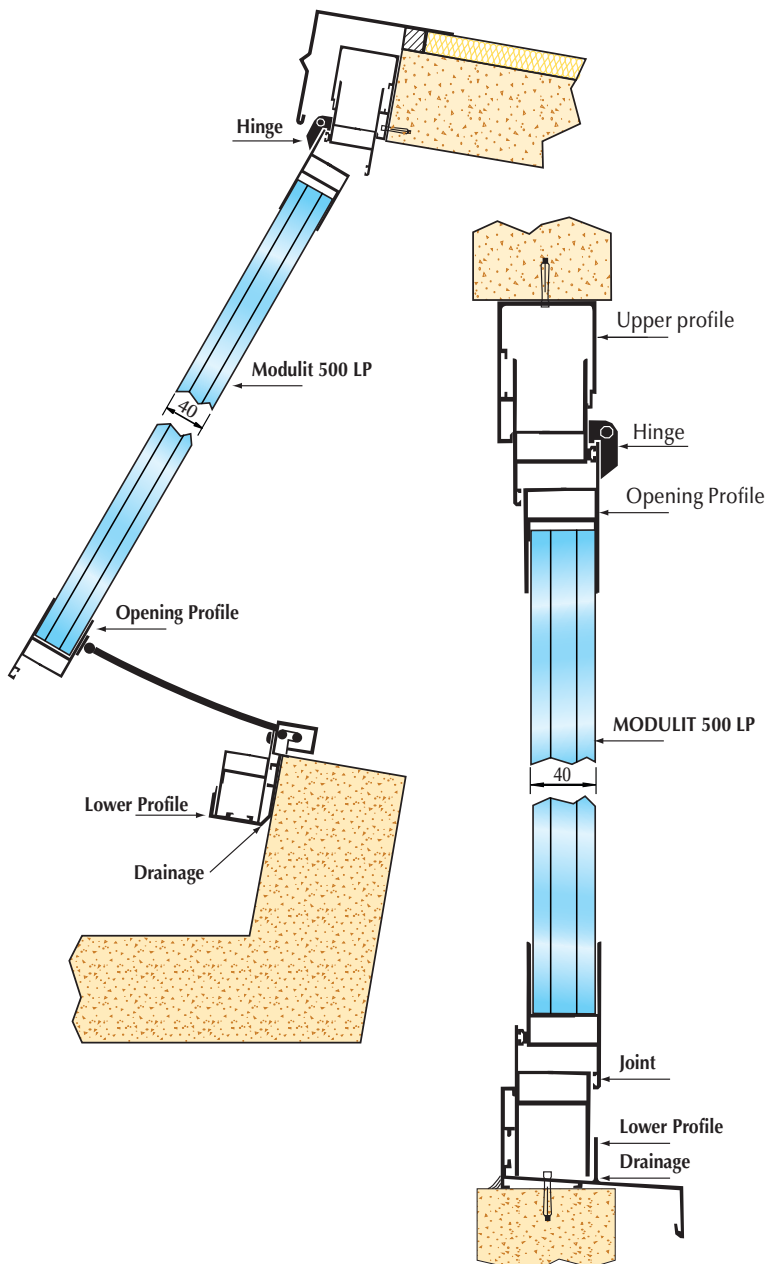

INTERIOR WALL SYSTEMS

CO-EX polycarbonate wall systems are ideal for use in vertical glazing for both interior and exterior use. When combined with colorful lighting effects, interior walls can become translucent panels that can change the mood of the room with a flick of a switch.

These effects can be translated into signage and tradeshow exhibit booths, which are economical, lightweight, and easy to transport. They are becoming a popular material for use in museums and retail establishments where unique lighting effects and economy are desired.

An ideal clerestory material, our modular wall system is perfect for areas requiring natural daylight without harsh shadows. And, with all of our fine products, our polycarbonate is co-extruded with U.V. protection to insure your interior colors resist fading.

Photos courtesy of EXTECH® Exterior Technologies:
above & below, Samsung Interior Partitions, NY, NY,
right, Mercedes Traveling Exhibit



SUGGESTED ARCHITECTURAL SYSTEM TESTING

TEST PERFORMANCE	
1. Self ignition temp	ASTM 1929-3
2. Smoke density	ASTM D- 2843
3. Burn extent	ASTM D-635
4. Interior flame spread	ASTM E-84
5. Color difference	ASTM D-2244-85
6. Accelerated outdoor weathering	ASTM D 4364
7. Yellowing index	ASTM 1925
8. Haze and luminous testing	ASTM D 1003
9. Air infiltration	ASTM E-283
10. Water penetration	ASTM E- 331
11. Load bearing capability	ASTM E-330-90
12. Thermal performance test	ASTM C1363
13. Solar properties	NFRC 201
14. OSHA fall and walk through protection	STD 29 CFR 1910.23(e) (8)
15. OSHA life safety STD 29 CFR 500 lbs	ASTM E-695-03

*Tests and certifications available and subject to
limitation on weight, section, colors, etc.*

CO-EX is a leading producer of polycarbonate modular panel systems. Our staff is at your disposal to answer any questions you may have concerning vertical, curved or pitched glazing. Our extensive range of quality sheet types and systems will suit most applications.

If you require custom solutions to a particular problem, our technical staff is here to support you, from planning to installation and all steps in between.

**CALL TODAY FOR
MORE INFORMATION**
(800) 888-5364